

04.GREEN TREE

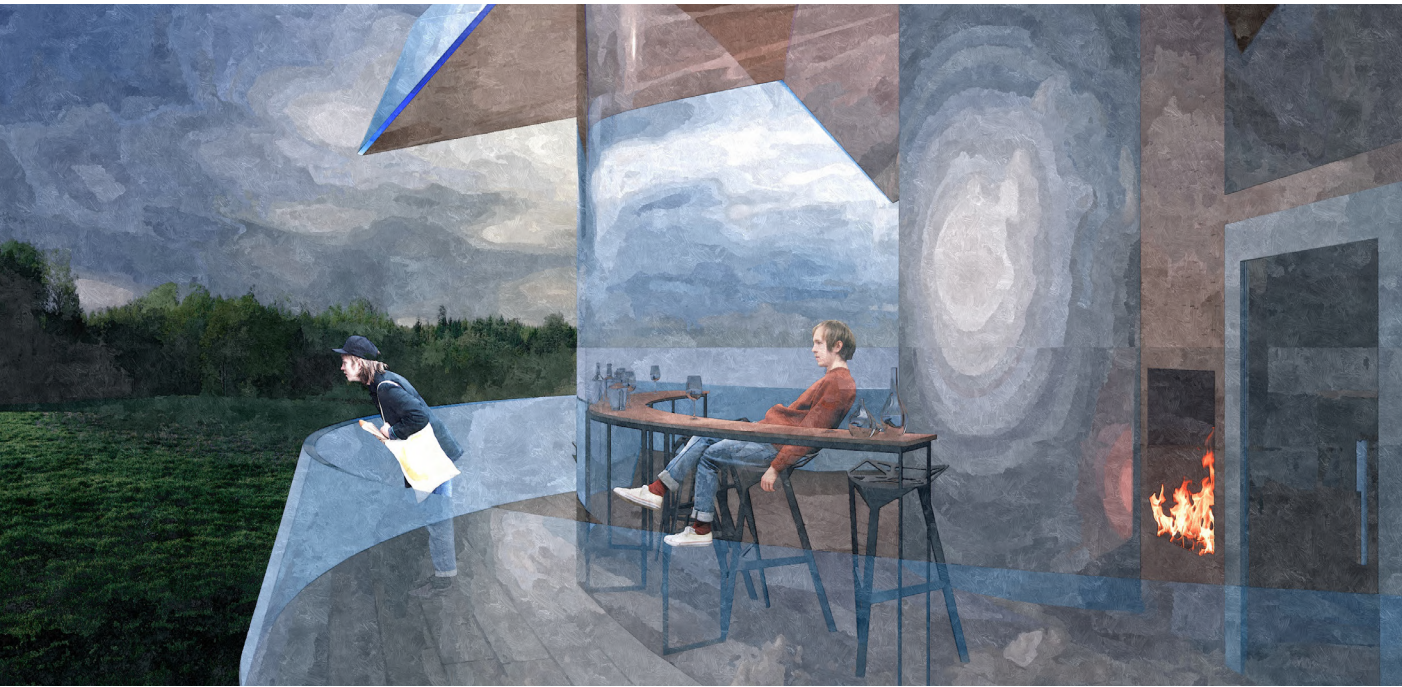
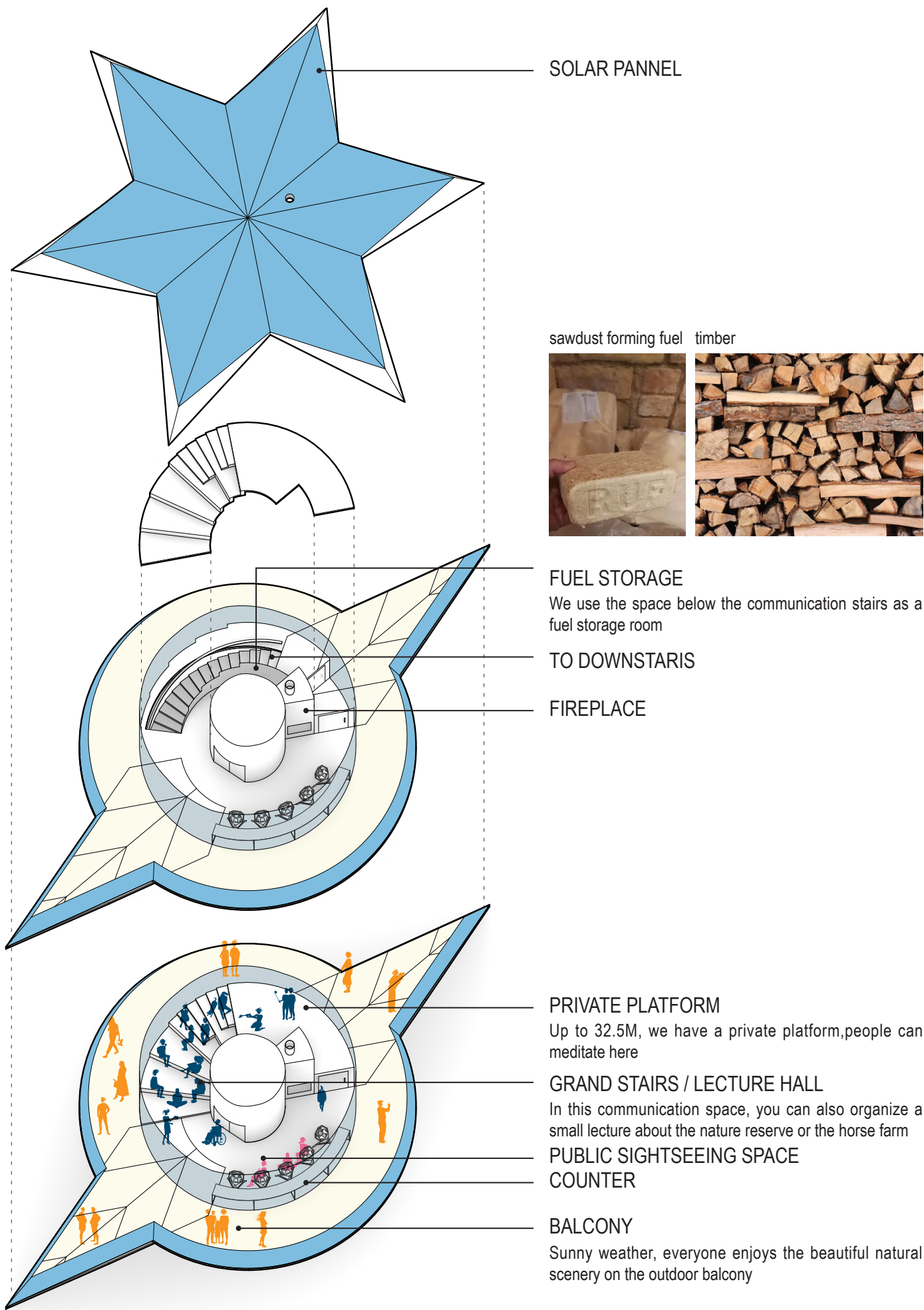

L5 FUNCTIONS

L5 can also offering an 360 view, the interior space is divided into three parts, the fist part is the public sightseeing space with counter and seats, so that people can enjoy the scenery in rainy and snowing days. The second part is a grand stairs, in this communication space, you can also organize a small lecture about the nature reserve or the horse farm. The third part is the platform above the grand stairs. This part is relatively private , people can observe, daze or have a meditation here.

HEATING RESOURCES

Due to the lack of energy in Latvia, we recommend biomass fuel fireplaces as the heating resourse for the fifth floor. There are forests around the farm, pruning and wood waste can be used as fuel. In addition, we can buy sawdust forming fuel. In rainy and snowing day, people can sitting around the fireplace and enjoy the beautiful scenery.

