

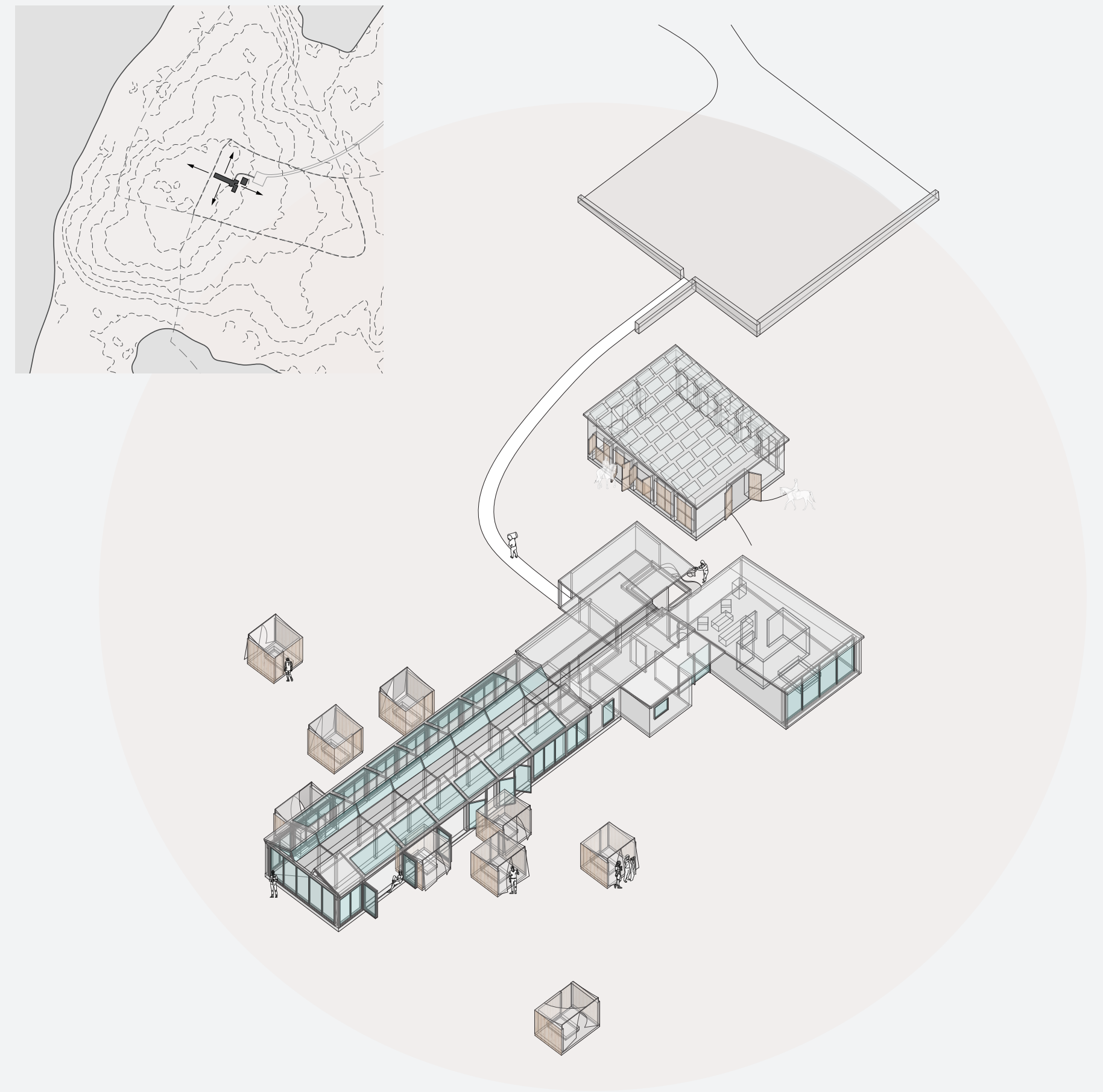

Långhus



Långhus

The Nordic longhouse, a narrow yet strong architectural symbol of the Nordic homestead at one time provided shelter and refuge to families of all sizes. Within its stone walls and earthy rooms there exists a nurturing retreat from the harsh winter landscape. Although the longhouse was built with thick walls that separated interior from exterior, the dwellers perceived its iconic formal qualities as a needed return to nature. This unyielding appreciation for the natural environment meant that the inhabitants needed to feel continually connected. This precedent is still a reality in Iceland today, as inhabitants explore the natural, intellectual qualities activities that become emergent in such a naturally isolating environment.

Långhus provides visitors with their own space to return to nature. As the detachable rooms separate from the main hall, they break modern convention and allow the visitor to focus on their own connection to the environment in their own way. Each visitor becomes a nomad of their own accord, free to roam, explore, relax, and learn at their own will. Seasonal changes highlight the buildings dynamic relationship with the environment As summer comes the moveable bedrooms expand out into the landscape, and as winter arrives the bedrooms may return to the warmth of the Långhus.

Structurally, Långhus finds inspiration from Nordic interventions as it is built primarily of locally sourced stone and earth. Responsible use of wood provides valuable warmth and texture within the home and each bedroom. The home is capable of containing each individual bedroom and sealing itself off from the elements, release each room to become a grand hall for large events.